



Installation Instructions

Heat Treated Front Sway Bar - Part# SS101

This part fits Ford F53 V10 Chassis (2000 & Up)

This product offers a stronger alternative to the traditional sway bar upgrade. When heat is applied during manufacturing, the steel hardens and becomes stronger. At 1 3/4" diameter, it is larger than the stock sway bar. For every 1/8" sway bar diameter size, you gain 30% increase in strength. This heat treated front sway bar kit also includes upgraded heavy duty end-links. They are thicker and stronger than the factory alternative, reducing the risk of breaking. **Installation time is 1-2 hours**

A qualified mechanic using normal automotive tools and following all safety measures known, should perform installation of this product.

SS101 HEAT TREATED FRONT SWAY BAR PARTS LAYOUT

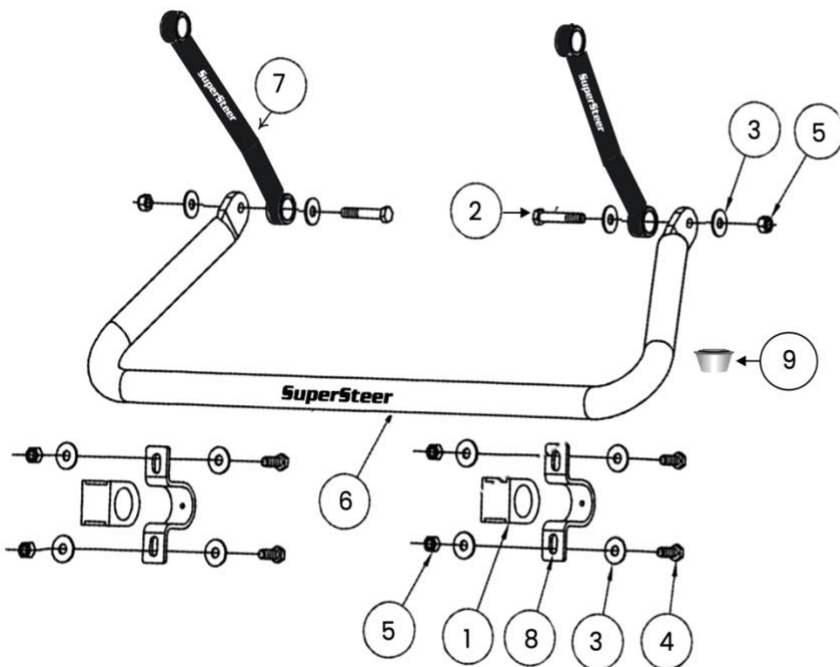

| ITEM | QTY | DESCRIPTION |
|------|-----|-----------------------------------|
| 1 | 2 | BUSHING |
| 2 | 2 | * 1/2 -13 x 3" BOLT - GRADE 8 |
| 3 | 12 | 1/2" FLAT WASHER |
| 4 | 4 | * 1/2 -13 x 1 2" BOLT - GRADE 8 |
| 5 | 6 | 1/2 -13 NYLON INSERT TOP LOCK NUT |
| 6 | 1 | SS-101 HEAT TREADED SWAY BAR |
| 7 | 2 | HEAVY DUTY SUPERSTEER ENDLINKS |
| 8 | 2 | BUSHING CLAMP |
| 9 | 1 | AQUALUBE |

*Torque spec on these bolts is 85 lbs.

Installation Instructions for Part #SS101 – Heat Treated Front Sway Bar

A. Preparation

Move the coach to a level, flat surface and set the brakes or you may drive the coach over a work pit and chock the front wheels. Block off adequate space at the front of the coach to work.

1. Remove the factory sway bar and the end-links.

Loosen the end-link bolts and allow the sway bar to hang by its center section. Remove the center section saddle brackets, by loosening the bolts that hold the saddle brackets to the axle. Then remove top bolts from the frame and remove end-links. Lower the bar to the ground (see photo).



Note: due to manufacturing variances, there may be only one bolt.

⚠ WARNING: Loosening the saddle bracket bolts will release the sway bar. The sway bar is heavy, and may cause property damage or personal injury if it falls on equipment, engine components or any part of your body. Ensure that the sway bar is supported and that you are out of the way when removing the bolts. **Failure to follow these instructions may cause property damage.**

2. Prepare the SS-101 sway bar for installation.

Grease the inside of the poly bushing (see photo). Use the provided lube to grease the inside of the poly bushings that fit around the sway bar. Use the old bar to determine the proper positioning of the bushings.

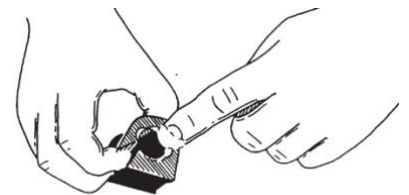

3. Move the SS-101 sway bar under the vehicle.

4. Install the SuperSteer heavy duty end-links.

Make sure the bend of heavy duty end-link is point to the INside and the long end is on the top. Also loosely attach the heavy duty end-links on the coach as you will use them to attach the SS-101 Sway bar.



5. Install the SS-101 sway bar.

Lift the heat treated SS-101 sway bar into place. Installing the bar is simply the reverse of removing it. Since the SS101 is heavier than the factory bar, it is always easier to install the sway bar with two people. Attach the SS-101 sway bar to the end-link fasteners in your kit. Swing the sway bar up and attach to the SuperSteer heavy duty end-links hanging down that you just installed in step 4.

6. Center the anti-sway bar and tighten.

Make sure that the SS-101 sway bar is centered equally between the heavy duty end-links, then tighten the fasteners.

7. Test drive the vehicle.

Drive the vehicle and then carefully check all the fasteners for proper tightness.

⚠ WARNING: After road testing, re-check all fasteners for proper tightness — if a fastener has worked loose or fallen off, re-tighten or replace it. Without all kit components properly tightened or in place, the anti-sway bar will not stabilize the vehicle at full capacity, which may cause reduced cornering ability or other reductions in vehicle handling or performance.

Failure to follow these instructions may result in property damage, personal injury or even death.

B. Installation Complete.

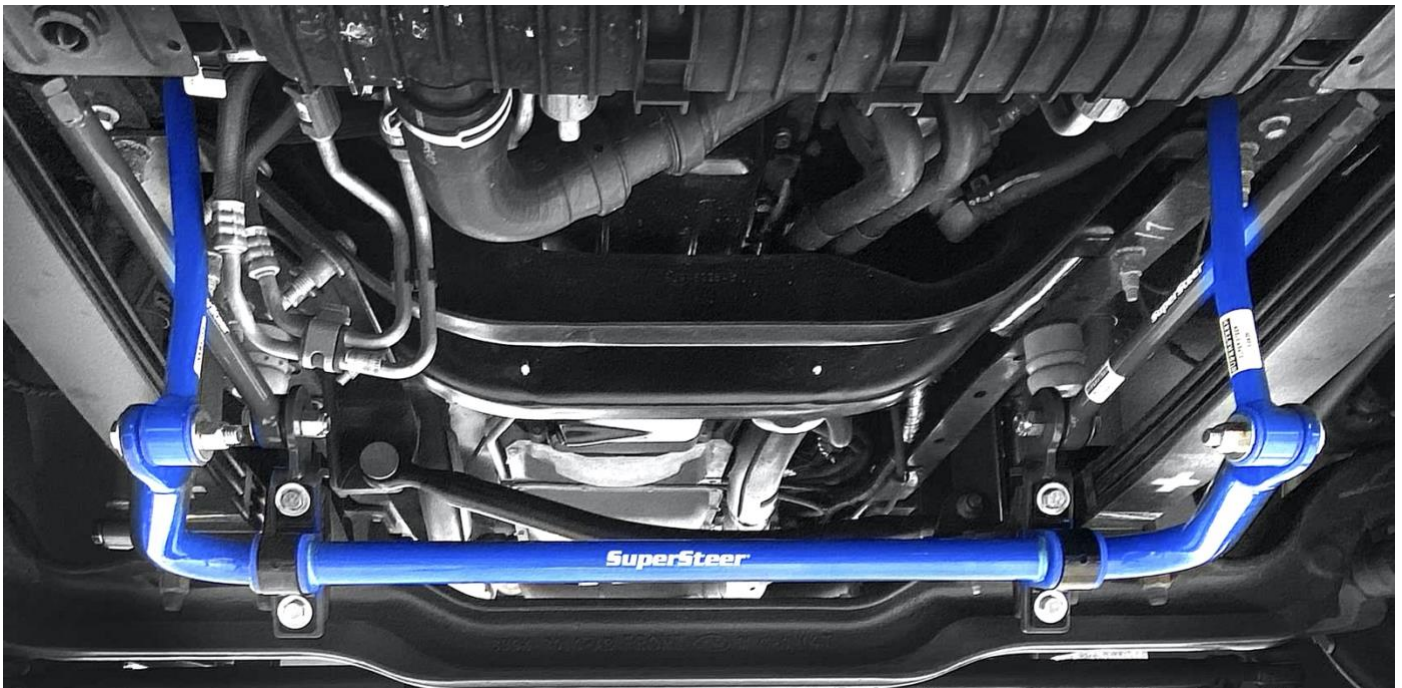

⚠ WARNING: The SS-101 sway bar is not a load-bearing component

Do not tow or hoist the vehicle using the SS-101 sway bar or its mounting brackets as attachment points. The sway bar is not designed to carry the weight of the vehicle and may collapse, which will damage the sway bar components, the suspension, or other components. The vehicle will detach or fall, which may cause severe personal injury. **Failure to follow these instructions may result in property damage, personal injury or even death.**

Your comments are greatly appreciated.
Please feel free to contact *SuperSteer*[®] at
888-898-3281 or e-mail at sales@supersteerparts.com

LIMITED LIFETIME SUPERSTEER WARRANTY

1. WARRANTY

1a. WARRANTY OF CONFORMITY AT TIME OF SALE

SUPERSTEER warrants that at the time of sale of this product it will be free from defects in material and manufacture and will conform to SUPERSTEER'S specifications for the product.

1b. CONDITIONAL LIMITED LIFETIME WARRANTY

In addition to the preceding time-of-sale warranty, if the product registration card is completely and accurately filled out and mailed to SUPERSTEER within thirty (30) days of purchase, SUPERSTEER will provide a Limited Lifetime warranty after sale the product will remain in good working order, PROVIDED THAT the product is installed and maintained in accordance with SUPERSTEER'S instructions and is not subjected to: (a) alteration or unauthorized repairs or repairs by anyone other than SUPERSTEER or a SUPERSTEER -authorized service center, (b) misuse, abuse, commercial use, or improper maintenance, (c) Acts of God (including without limitation hurricanes, tornadoes, floods, or other severe weather or natural phenomena), (d) failures due to products not supplied by SUPERSTEER, or (e) other treatments, uses, or installations for which the product was not intended. This warranty extends only to the first retail purchaser-consumer of the product and is not transferable.

EXTENDED WARRANTY PERIOD: If SUPERSTEER receives the product registration card, completely and accurately filled out, within twenty (20) days of purchase, SUPERSTEER will enlarge the one-year warranty period in the preceding paragraph to a period of two years.

2. DISCLAIMER OF OTHER WARRANTIES

The preceding warranties are the exclusive and sole express warranties given by SUPERSTEER. They supersede any prior, contrary or additional representations, whether oral or written. No agent, representative, dealer or employee has the authority to alter or increase the obligations or limitations of this warranty. Any implied warranties, including the WARRANTY OF MERCHANTABILITY and any WARRANTY OF FITNESS FOR A PARTICULAR PURPOSE, are limited in duration to thirty days or the term of the applicable express warranty provided above, whichever is longer. Some states do not allow limitations on how long an implied warranty lasts, so the above limitation may not apply to you.

3. EXCLUSIVE REMEDY FOR ANY NONCONFORMITIES

If during the applicable Warranty Period, the product does not conform to the preceding Warranties, notify SUPERSTEER as provided below, and within a reasonable time SUPERSTEER will provide, at its option, one of the following: (1) replacement components for any nonconforming or defective product or components or (2) the percentage of the purchase price for the nonconforming product equal to the percentage of the Warranty Period remaining when SUPERSTEER is notified of the nonconformity. SUPERSTEER will, at its option, (a) use new and/or reconditioned parts in performing warranty repairs and making replacement products, (b) use parts or products of original or improved design in the repair or replacement. If SUPERSTEER repairs or replaces a product, its warranty continues for the remaining portion of the original Warranty Period or 60 days from the date of the return shipment to the customer, whichever is greater. All replaced products and all parts removed from repaired products become the property of SUPERSTEER. SUPERSTEER will not provide, and will not be liable for, labor, costs of removal or reinstallation of components, disposal, shipping, freight, taxes, or other incidental charges.

4. DISCLAIMER OF INCIDENTAL AND CONSEQUENTIAL DAMAGES

For any breach of warranty, the Owner must telephone SUPERSTEER at 1-888-898-3281 within thirty (30) days after discovering the nonconformity. Do not return any product without first calling SUPERSTEER and getting a return authorization number. Returned products must include the return authorization number and a copy of the original invoice, bill or other proof of the date of purchase. The date of purchase must coincide with the original warranty registration card on file. SUPERSTEER will authorize (a) shipment of the product to SUPERSTEER or (b) repair or replacement at the nearest warranty service center—in both cases with shipping at your expense. Do not purchase replacement parts or pay for repair labor—you will not be reimbursed. Compliance with the requirements of this paragraph is a condition to coverage under the Warranty: if these requirements are not complied with, SUPERSTEER will have no obligation to provide any remedy for any breach of warranty.

4. DISCLAIMER OF INCIDENTAL AND CONSEQUENTIAL DAMAGES

IN NO EVENT SHALL SUPERSTEER BE LIABLE FOR ANY INCIDENTAL, SPECIAL, INDIRECT OR CONSEQUENTIAL DAMAGES, WHETHER RESULTING FROM NONDELIVERY OR FROM THE USE, MISUSE OR INABILITY TO USE THE PRODUCT OR FROM DEFECTS IN THE PRODUCT.

Some states do not allow the exclusion or limitation of incidental or consequential damages, so the above limitation may not apply to you.

5. APPLICABLE LAW

This Warranty will be interpreted, construed, and enforced in all respects in accordance with the laws of the State of Washington, without reference to its choice of law rules. The U.N. Convention on Contracts for the International Sale of Goods will not apply to this Warranty.

6. SEVERABILITY

If any provision of this warranty is found to be invalid or unenforceable, then the remainder shall have full force and effect, and the invalid provision shall be partially enforced to the maximum extent permitted by law to effectuate the purpose of the agreement.

7. ADDRESS FOR NOTICES TO SUPERSTEER

SuperSteer, 458 Redwood Hwy, Grants Pass Oregon 97527

This warranty gives you specific legal rights, and you may also have other rights which vary from State to State.